

BSTP2.8 (50-30) -230- 304				
TYPE	Ø	LENGTH	LENGTH	ALLOY
		R A	L	

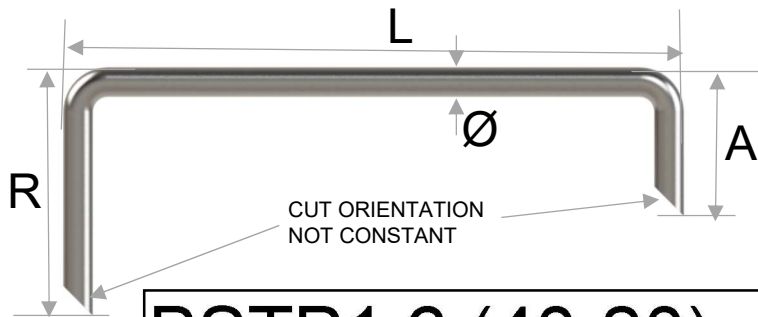

BSTP1.6 (40-20) -150- 310				
TYPE	Ø	LENGTH	LENGTH	ALLOY
		R A	L	

Anchors are manufactured with a DIN EN 10278 (DIN 671) cold drawn wire, by robots using hydraulic tools.
That allows minimizing bend marking and avoids micro cracks

ANCHORING 2 BRICKS

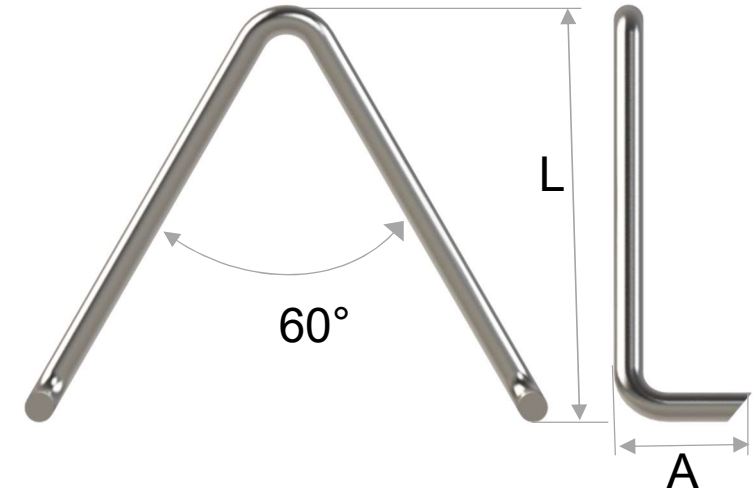

BSTP3.6 -100-25 (60) - 310					
TYPE	Ø	LENGTH	LENGTH	ANGLE	ALLOY
		L	A		

www.anchorsforrefractory.com
contact@anchorsforrefractory.com



Tél : + 33 3 66 50 00 33 / +33 7 85 06 29 49
PA Vallée de l'Escaut - rue de la crête - 59264 ONNAING-France

These informations are general informative indications. Many particular conditions of use and exceptions exist in industrial applications, many parameters can influence the technical choices. The informations mentioned in this technical data sheet, in particular regarding the features and the performances of the products, is provided for guidance purposes only and is liable to change depending of the conditions of use and environment. Information mentioned can be modified without notice. The company ANCHORS will in no circumstances be held liable for the consequences of any improper use. If you want some suggestions from us, applicable for your specific application and/or environment, please contact us.