

- Ø 8 - C= 30 mm
- Ø 10 - C= 35 mm
- Ø 12 - C= 40 mm

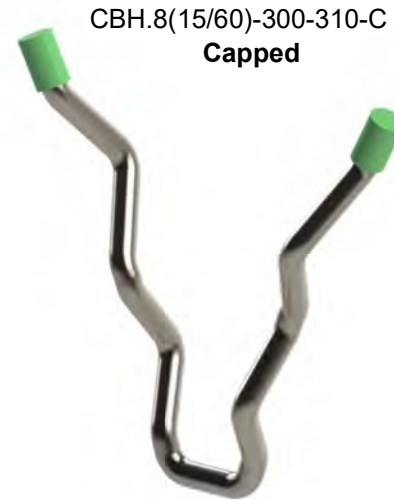

OPTIONS



Our recommendations:

- For thicker linings
- The 2 angles limit the opening at the head of the anchors.
- Always cap your anchors, it will give a small space into which the thermal expansion steel alloy (higher than castable) can move without creating stress and possibly damaging in the castable.

# CBH.8 (15/60) -300- 310

TYPE	Ø D	ANGLE A/B	LENGTH L	ALLOY
------	-----	--------------	-------------	-------

Anchors are manufactured with a DIN EN 10278 (DIN 671) cold drawn wire, by robots using hydraulic tools. That allows minimizing bend marking and avoids micro cracks

www.anchorsforrefractory.com  
contact@anchorsforrefractory.com



Tél : + 33 3 66 50 00 33 / +33 7 85 06 29 49  
PA Vallée de l'Escaut - rue de la crête - 59264 ONNAING-France

These informations are general informative indications. Many particular conditions of use and exceptions exist in industrial applications, many parameters can influence the technical choices. The informations mentioned in this technical data sheet, in particular regarding the features and the performances of the products, is provided for guidance purposes only and is liable to change depending of the conditions of use and environment. Information mentionned can be modified without notice. The company ANCHORS will in no circumstances be held liable for the consequences of any improper use. If you want some suggestions from us, applicable for your specific application and/or environment, please contact us.

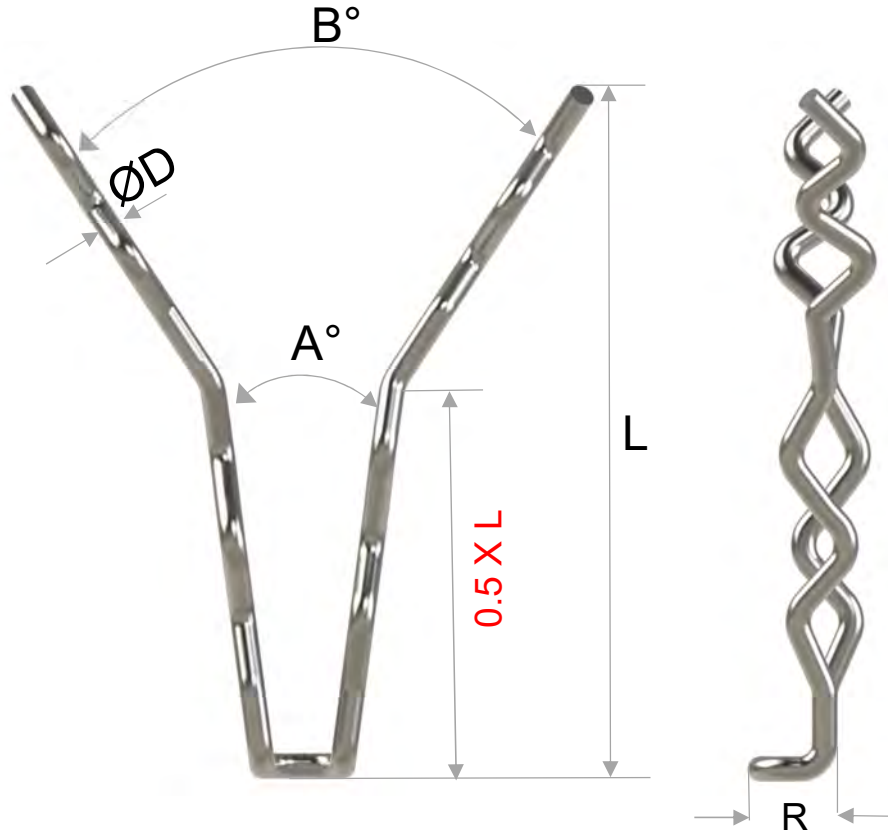

CBH.SG.8(15/55)-300-38-253MA-C

Capped

CBH.SG.8(15/55)-300/280-38-310

Unequal legs

OPTIONS

- Ø 6 - R= 32 mm
- Ø 8 - R= 38 mm
- Ø 10 - R= 48 mm
- Ø 12 - R= 50 mm

Our recommendations:

- The bent foot allows easier 90° positioning on steel casing and makes welding longer/stronger
- The 2 angles limit the opening at the head of the anchors.
- Always cap your anchors, it will give a small space into which the thermal expansion steel alloy (higher than castable) can move without creating stress and possibly damaging in the castable.

**CBH.SG.8 (15/55) -300-38- 310**

TYPE	Ø D	ANGLE A/B	LENGTH L	LENGTH R	ALLOY
CBH.SG.8 (15/55)	8	15/55	300	38	310

Anchors are manufactured with a DIN EN 10278 (DIN 671) cold drawn wire, by robots using hydraulic tools. That allows minimizing bend marking and avoids micro cracks

[www.anchorsforrefractory.com](http://www.anchorsforrefractory.com)  
[contact@anchorsforrefractory.com](mailto:contact@anchorsforrefractory.com)



Tél : + 33 3 66 50 00 33 / +33 7 85 06 29 49  
 PA Vallée de l'Escaut - rue de la crête - 59264 ONNAING-France

These informations are general informative indications. Many particular conditions of use and exceptions exist in industrial applications, many parameters can influence the technical choices. The informations mentioned in this technical data sheet, in particular regarding the features and the performances of the products, is provided for guidance purposes only and is liable to change depending of the conditions of use and environment. Information mentionned can be modified without notice. The company ANCHORS will in no circumstances be held liable for the consequences of any improper use. If you want some suggestions from us, applicable for your specific application and/or environment, please contact us.

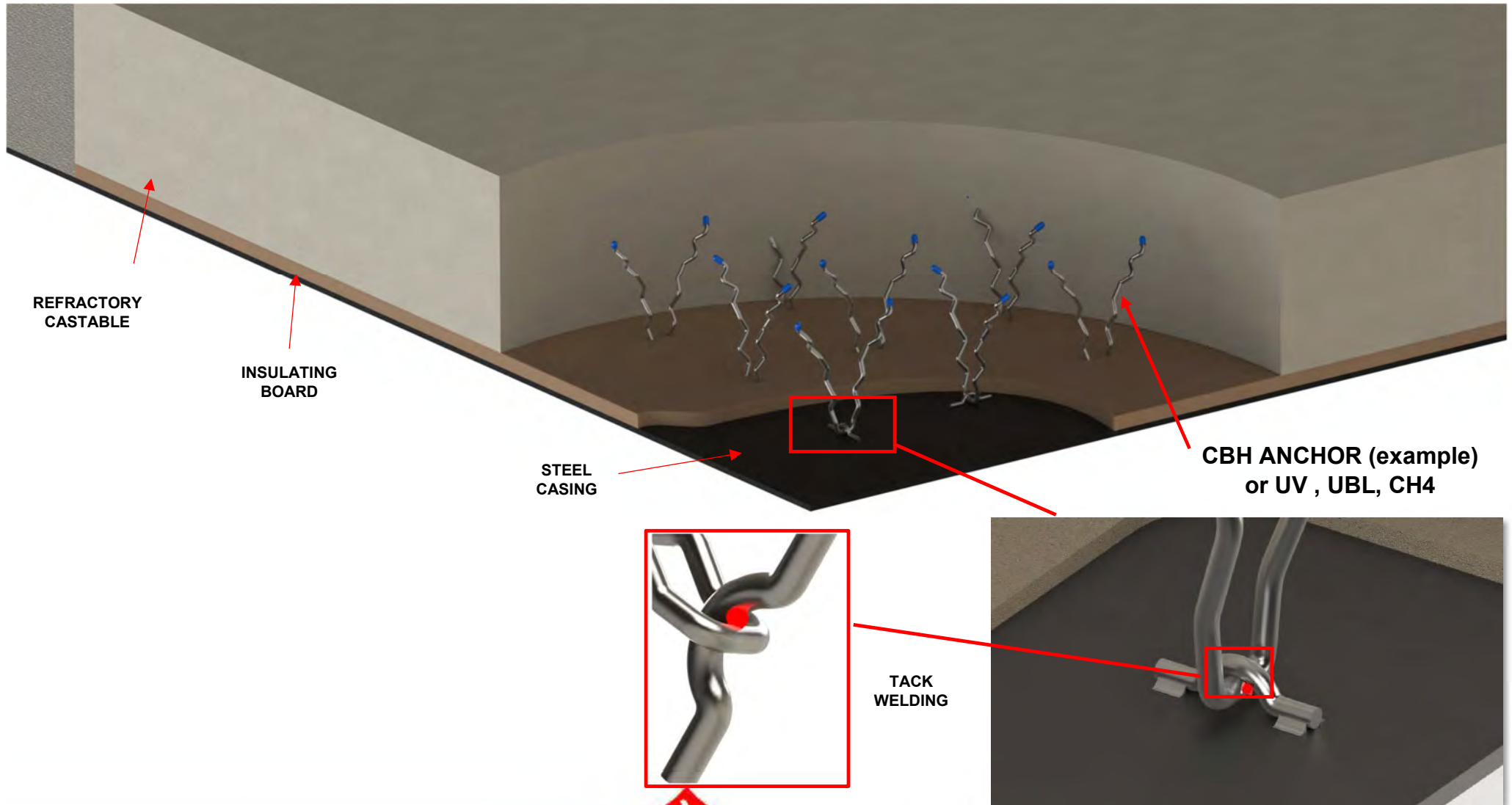

[www.anchorsforrefractory.com](http://www.anchorsforrefractory.com)  
[contact@anchorsforrefractory.com](mailto:contact@anchorsforrefractory.com)



Tél : + 33 3 66 50 00 33 / +33 7 85 06 29 49  
 PA Vallée de l'Escaut - rue de la crête - 59264 ONNAING-France

These informations are general informative indications. Many particular conditions of use and exceptions exist in industrial applications, many parameters can influence the technical choices. The informations mentioned in this technical data sheet, in particular regarding the features and the performances of the products, is provided for guidance purposes only and is liable to change depending of the conditions of use and environment. Information mentionned can be modified without notice. The company ANCHORS will in no circumstances be held liable for the consequences of any improper use. If you want some suggestions from us, applicable for your specific application and/or environment, please contact us.

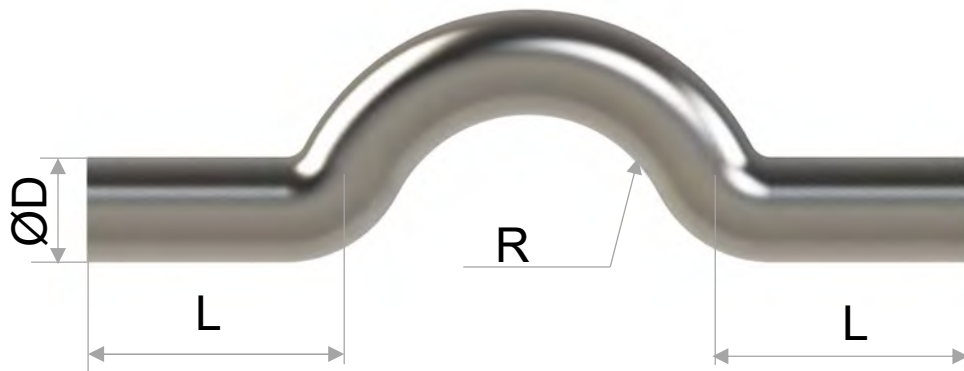

WB.10-R16/30-253MA



WB.6-R12/25-253MA



**WB.8.R14/25 - 253MA**

TYPE	Ø D	RADIUS / LENGTH	ALLOY
		R L	

**NB : L minimum 25 mm**

Anchors are manufactured with a DIN EN 10278 (DIN 671) cold drawn wire, by robots using hydraulic tools. That allows minimizing bend marking and avoids micro cracks

[www.anchorsforrefractory.com](http://www.anchorsforrefractory.com)  
[contact@anchorsforrefractory.com](mailto:contact@anchorsforrefractory.com)



Tél : + 33 3 66 50 00 33 / +33 7 85 06 29 49  
 PA Vallée de l'Escaut - rue de la crête - 59264 ONNAING-France

These informations are general informative indications. Many particular conditions of use and exceptions exist in industrial applications, many parameters can influence the technical choices. The informations mentioned in this technical data sheet, in particular regarding the features and the performances of the products, is provided for guidance purposes only and is liable to change depending of the conditions of use and environment. Information mentionned can be modified without notice. The company ANCHORS will in no circumstances be held liable for the consequences of any improper use. If you want some suggestions from us, applicable for your specific application and/or environment, please contact us.

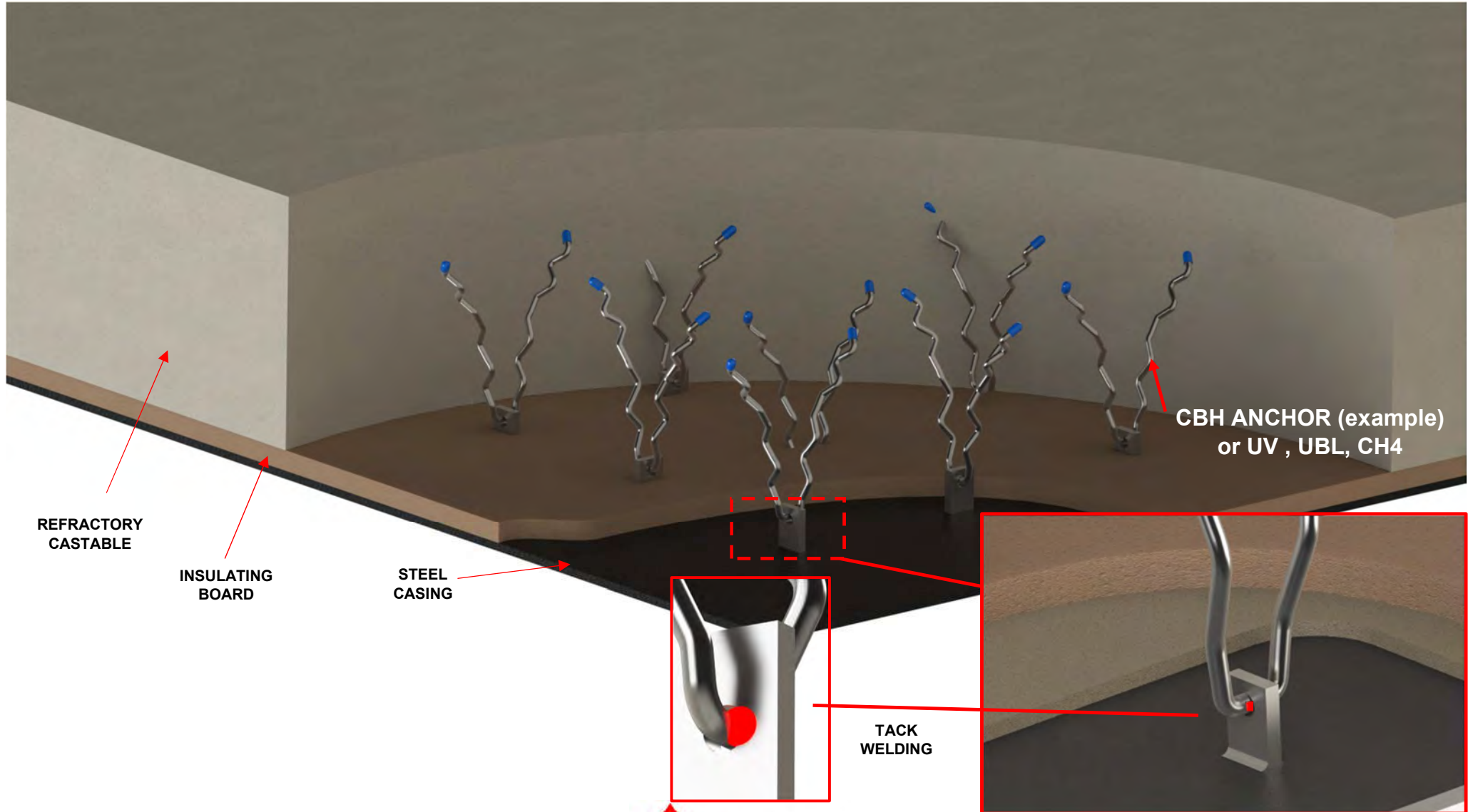

[www.anchorsforrefractory.com](http://www.anchorsforrefractory.com)  
[contact@anchorsforrefractory.com](mailto:contact@anchorsforrefractory.com)

Tél : + 33 3 66 50 00 33 / +33 7 85 06 29 49  
 PA Vallée de l'Escaut - rue de la crête - 59264 ONNAING-France

These informations are general informative indications. Many particular conditions of use and exceptions exist in industrial applications, many parameters can influence the technical choices. The informations mentioned in this technical data sheet, in particular regarding the features and the performances of the products, is provided for guidance purposes only and is liable to change depending of the conditions of use and environment. Information mentionned can be modified without notice. The company ANCHORS will in no circumstances be held liable for the consequences of any improper use. If you want some suggestions from us, applicable for your specific application and/or environment, please contact us.



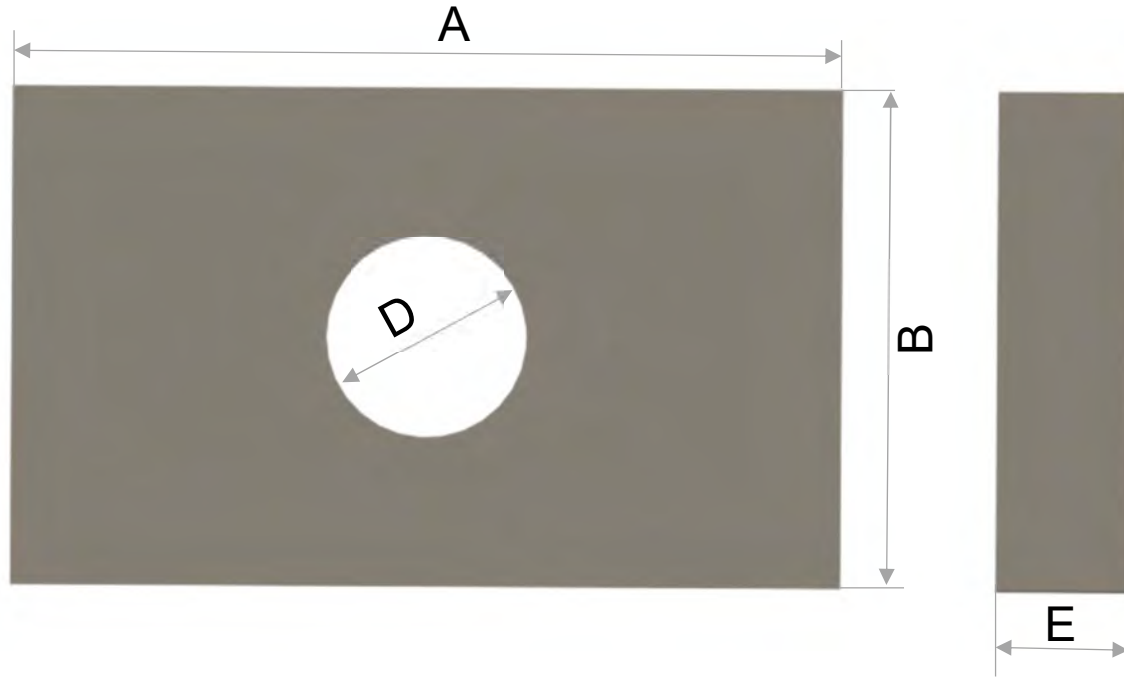

CBH.8(60/15)-200-253MA C  
 IN BSP.75.50.10-12(20).310



UBL.6(90/90)-060/025-310  
 IN BSP.25.20.5 (14X8).310

TECK  
 WELDING



<b>BSP.50. 30. 8-12 - 310</b>				
TYPE	LENGTH	LENGTH E	D	ALLOY
	A	B		



www.anchorsforrefractory.com  
 contact@anchorsforrefractory.com

Tél : + 33 3 66 50 00 33 / +33 7 85 06 29 49  
 PA Vallée de l'Escaut - rue de la crête - 59264 ONNAING-France

These informations are general informative indications. Many particular conditions of use and exceptions exist in industrial applications, many parameters can influence the technical choices. The informations mentioned in this technical data sheet, in particular regarding the features and the performances of the products, is provided for guidance purposes only and is liable to change depending of the conditions of use and environment. Information mentionned can be modified without notice. The company ANCHORS will in no circumstances be held liable for the consequences of any improper use. If you want some suggestions from us, applicable for your specific application and/or environment, please contact us.

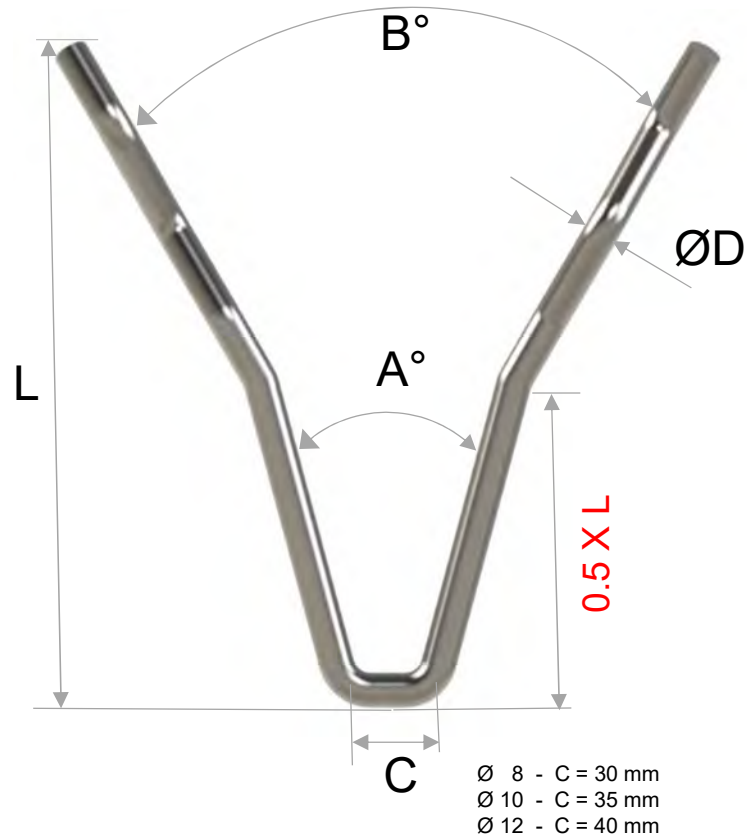

OPTION  
WITH PLASTIC CAPS



RVO .8(15/60) -100 - 253MA-C

<b>RVO .8(15/60) -100 - 253MA</b>				
TYPE	Ø D	ANGLE A/B	LENGTH L	ALLOY

Anchors are manufactured with a DIN EN 10278 (DIN 671) cold drawn wire, by robots using hydraulic tools.  
That allows minimizing bend marking and avoids micro cracks

[www.anchorsforrefractory.com](http://www.anchorsforrefractory.com)  
[contact@anchorsforrefractory.com](mailto:contact@anchorsforrefractory.com)



Tél : + 33 3 66 50 00 33 / +33 7 85 06 29 49  
PA Vallée de l'Escaut - rue de la crête - 59264 ONNAING-France

These informations are general informative indications. Many particular conditions of use and exceptions exist in industrial applications, many parameters can influence the technical choices. The informations mentioned in this technical data sheet, in particular regarding the features and the performances of the products, is provided for guidance purposes only and is liable to change depending of the conditions of use and environment. Information mentionned can be modified without notice. The company ANCHORS will in no circumstances be held liable for the consequences of any improper use. If you want some suggestions from us, applicable for your specific application and/or environment, please contact us.

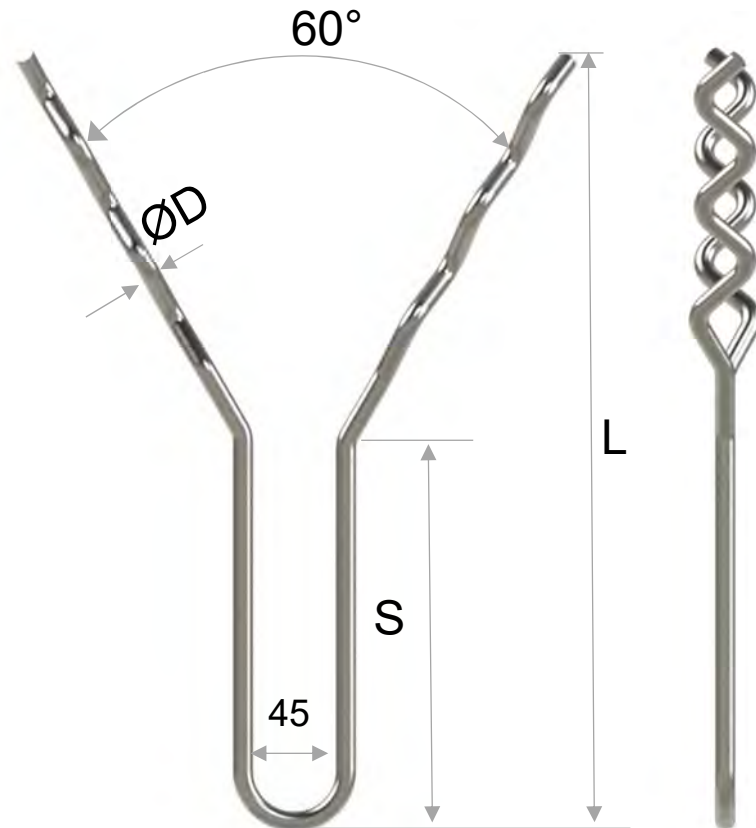

OPTION  
WITH PLASTIC CAPS



**HAL.8 (60) -300 (150)- 45- 253MA**

TYPE Ø D ANGLE LENGTH L STEP S ALLOY

**HAL.8 (60) -300 (150)- 45- 253MA-C**

Anchors are manufactured with a DIN EN 10278 (DIN 671) cold drawn wire, by robots using hydraulic tools.  
That allows minimizing bend marking and avoids micro cracks

[www.anchorsforrefractory.com](http://www.anchorsforrefractory.com)  
[contact@anchorsforrefractory.com](mailto:contact@anchorsforrefractory.com)



Tél : + 33 3 66 50 00 33 / +33 7 85 06 29 49  
PA Vallée de l'Escaut - rue de la crête - 59264 ONNAING-France

These informations are general informative indications. Many particular conditions of use and exceptions exist in industrial applications, many parameters can influence the technical choices. The informations mentioned in this technical data sheet, in particular regarding the features and the performances of the products, is provided for guidance purposes only and is liable to change depending of the conditions of use and environment. Information mentioned can be modified without notice. The company ANCHORS will in no circumstances be held liable for the consequences of any improper use. If you want some suggestions from us, applicable for your specific application and/or environment, please contact us.



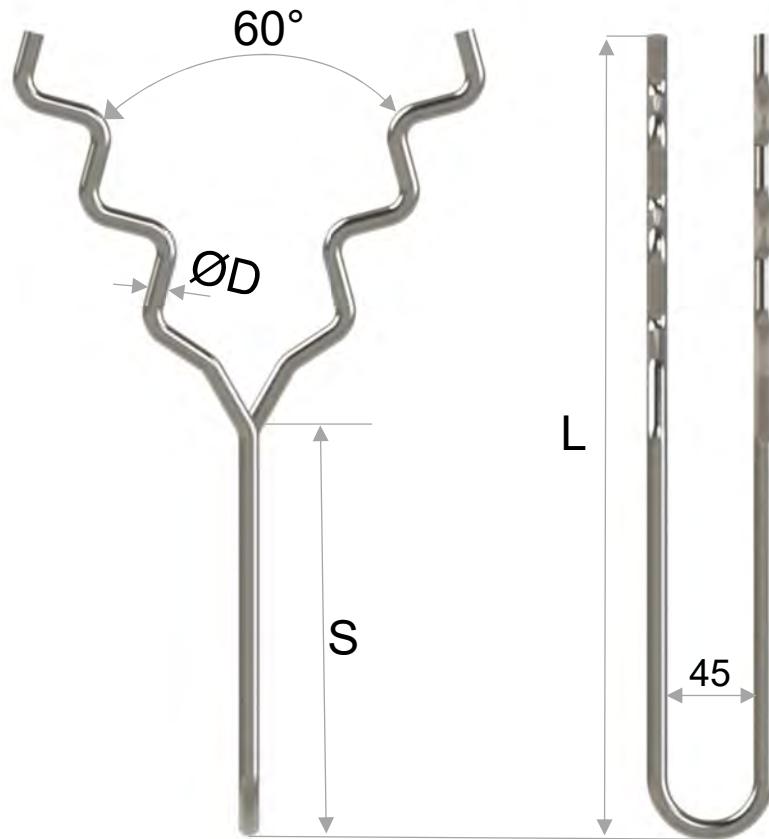

**HAR.8 (60) -300 (150)- 45- 253MA**  
 TYPE Ø D ANGLE LENGTH L STEP S ALLOY

OPTION  
 WITH PLASTIC CAPS



**HAR.8 (60) -300 (150)- 45- 253MA-C**

Anchors are manufactured with a DIN EN 10278 (DIN 671) cold drawn wire, by robots using hydraulic tools.  
 That allows minimizing bend marking and avoids micro cracks

[www.anchorsforrefractory.com](http://www.anchorsforrefractory.com)  
[contact@anchorsforrefractory.com](mailto:contact@anchorsforrefractory.com)



Tél : + 33 3 66 50 00 33 / +33 7 85 06 29 49  
 PA Vallée de l'Escaut - rue de la crête - 59264 ONNAING-France

These informations are general informative indications. Many particular conditions of use and exceptions exist in industrial applications, many parameters can influence the technical choices. The informations mentioned in this technical data sheet, in particular regarding the features and the performances of the products, is provided for guidance purposes only and is liable to change depending of the conditions of use and environment. Information mentioned can be modified without notice. The company ANCHORS will in no circumstances be held liable for the consequences of any improper use. If you want some suggestions from us, applicable for your specific application and/or environment, please contact us.